

MARK	REVISIONS NO	REASONABLE RVISIONS	DATE	DWN	APVD

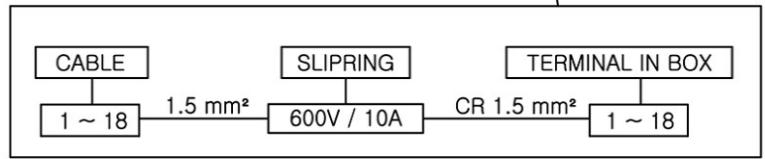
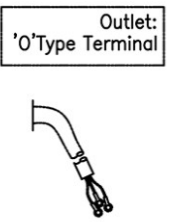
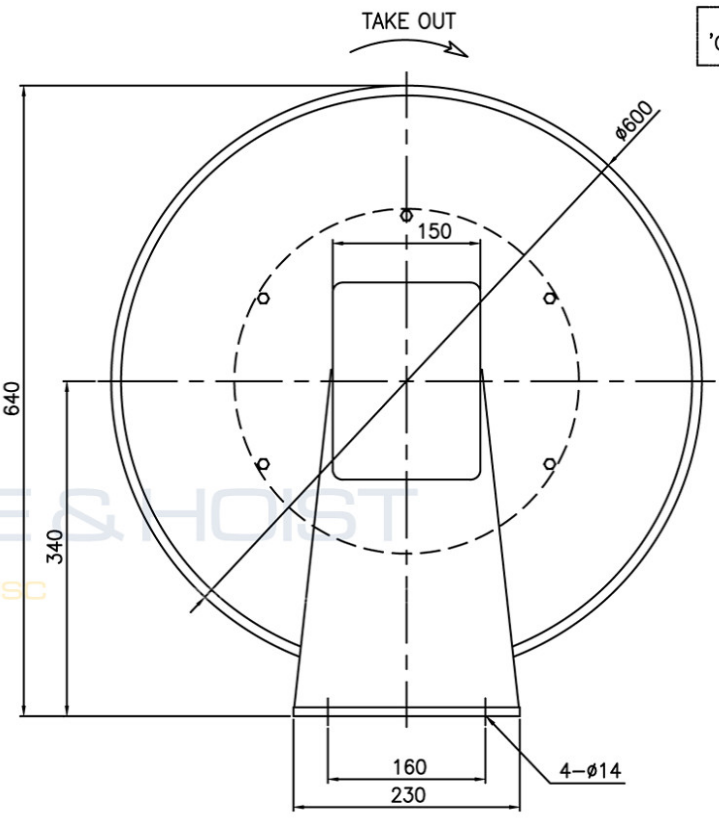
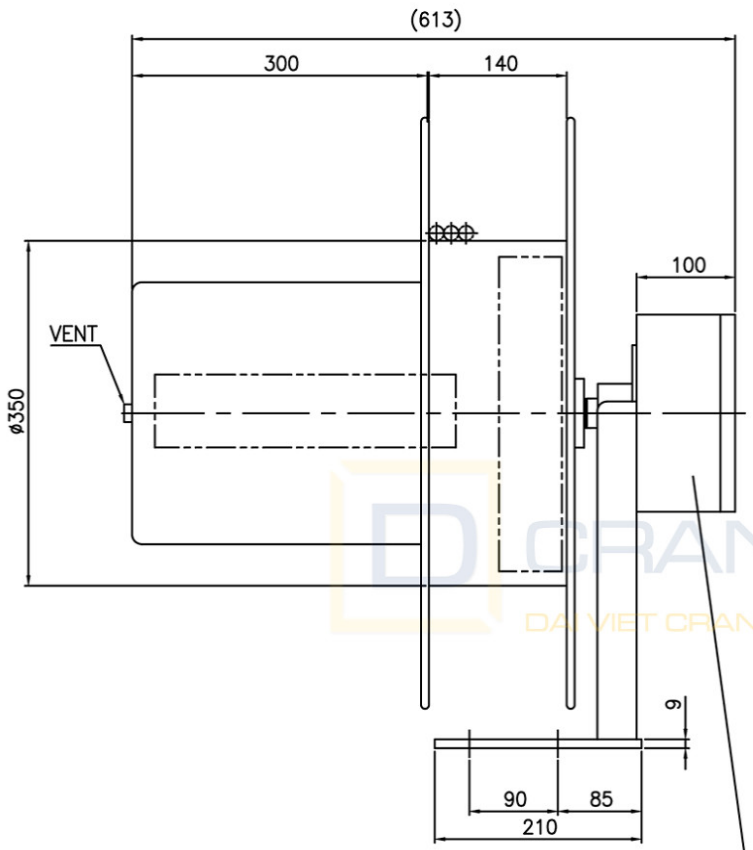
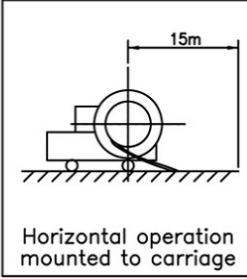
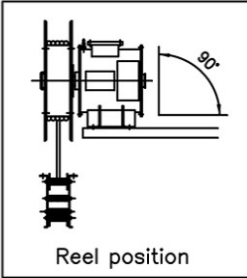
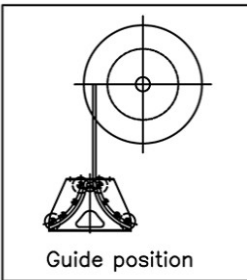

SPECIFICATION

- | | | | |
|-------------------|----------------------|-------------------|--------------------------------------|
| 1. Cable | o PNCT 1.5 sq x 18c | 5. Slip Ring | : 10A x 18P |
| o Size | : approx. Ø24.2mm | 6. Paint Color | : MUNSELL No. 7.5 BG6/1.5 (Out Door) |
| o Weight | : approx. 0.806 kg/m | 7. Setting Height | : Max. 1.0 m from G.L. |
| o Length | : 15 M | 8. Q' ty | : 1 Set |
| 2. Winding Length | : 15 M | 9. Weight | : - Kg |
| 3. Winding Speed | : max. 20 M/MIN | | |
| 4. Winding Torque | : 2 Kg.m | | |

ITEM	PARTS NO.	PART NAME	MATERIAL	Q'TY	REMARKS
6	-	FRAME ASS'Y	SPHC	1	
5	-	DRUM ASS'Y	SPCC	2	
4	-	TERMINAL BOX	PLASTIC	1	
3	-	SLIP RING	C3771	18	
2	-	SPRING	ATX	2	
1	-	CABLE	PNCT	18M	

PROJECTION	DIMENSIONS	SCALE	MODEL
3rd ANGLE	METRIC (mm)	1 : 8	ECC-118-18-R
CUSTOMER			PART NAME
MODEL COLOR			ASS'Y
			PART NO.
			Z829-9000
DRAWING	DESIGN	CHECK	APPROVAL
SIGN	P.S.Y		
DATE	2017.3.10		



A4(210X297)